



INSTALLATION INSTRUCTIONS

Accessory
PARTICLE SEPARATOR
 P/N 0SB01-HL6-A01

Application
**SXS1000S2X/S2XD/S2R/
 S2RD/S4X/S4XD**

Publication No.
MII 17811
 Issue Date
May 2022

Honda Dealer: Please give a copy of these instructions to your customer.

PARTS LIST

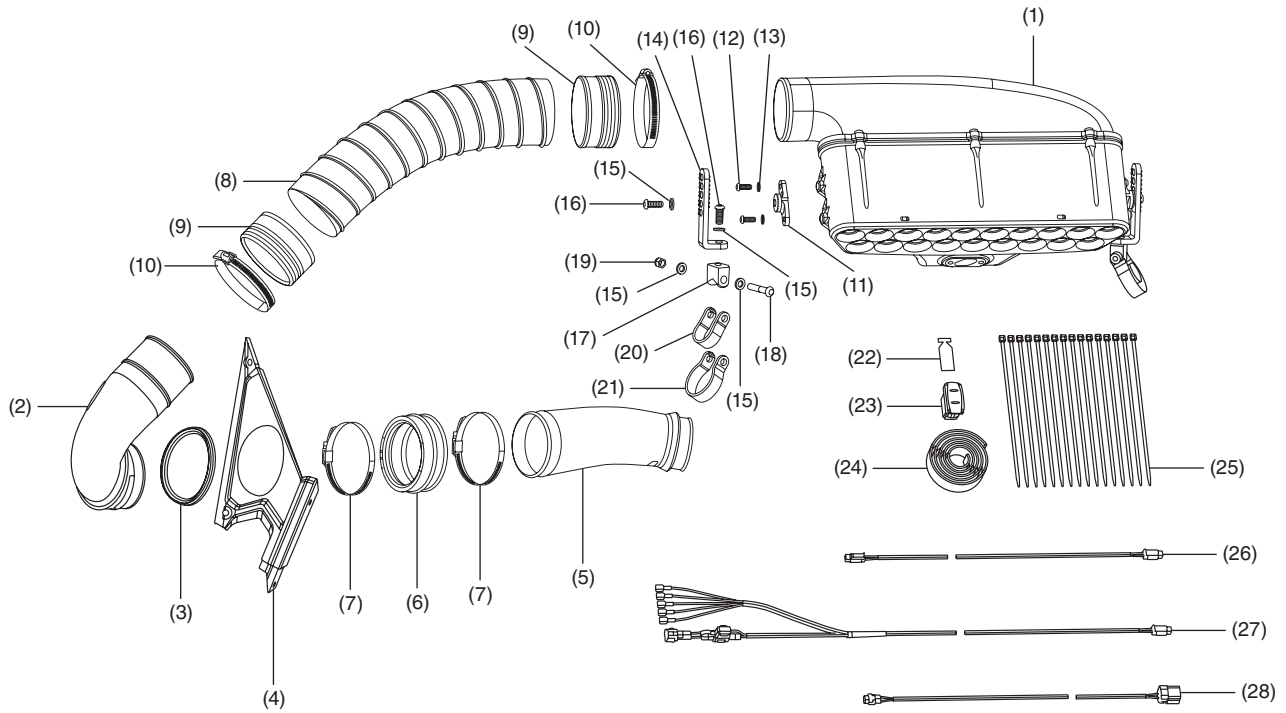

No.	Description	Qty
(1)	Particle separator unit	1
(2)	Upper tube	1
(3)	Grommet	1
(4)	Side cover	1
(5)	Lower tube	1
(6)	Coupler	1
(7)	Hose clamp, size #48	2
(8)	3.5 in id flexible duct	1
(9)	Flex duct end cuff	2
(10)	Hose clamp, size #56	2
(11)	Clamp adapter	2
(12)	6 × 18 mm button head cap screw	4
(13)	6 mm washer	4
(14)	Clamp L-bracket	2
(15)	8 mm washer	8
(16)	8 × 22 mm button head cap screw	4
(17)	Clamp pivot	2
(18)	8 × 50 mm button head cap screw	2

No.	Description	Qty
(19)	8 mm locknut	2
(20)	35 mm strap	2
(21)	2.00 in strap	2
(22)	Threadlocker	1
(23)	Rocker switch	1
(24)	1 in wide attachment strap	1
(25)	Cable tie	16
(26)	Wire harness extension	1
(27)	Wire harness, honda talon	1
(28)	Wire harness, fuse box adapter	1

Model Year Requirements

For installation on **Model Year 2021 and prior:**

Required Accessory:

OSA30-HL6-A00 Switch Plate harness with volt meter

For installation on **Model Year 2022 ~ present:**

Required Accessories:

0SS25-HL4-A00 Fuse Box

0SS26-HL6-A00 Fuse Box Mount Kit

0SS27-HL6-A00 Busbar

Switch Plate / Wire Harness with Volt Meter

Sold separately (P/N OSA30-HL6-A00)

Used on 21MY and previous

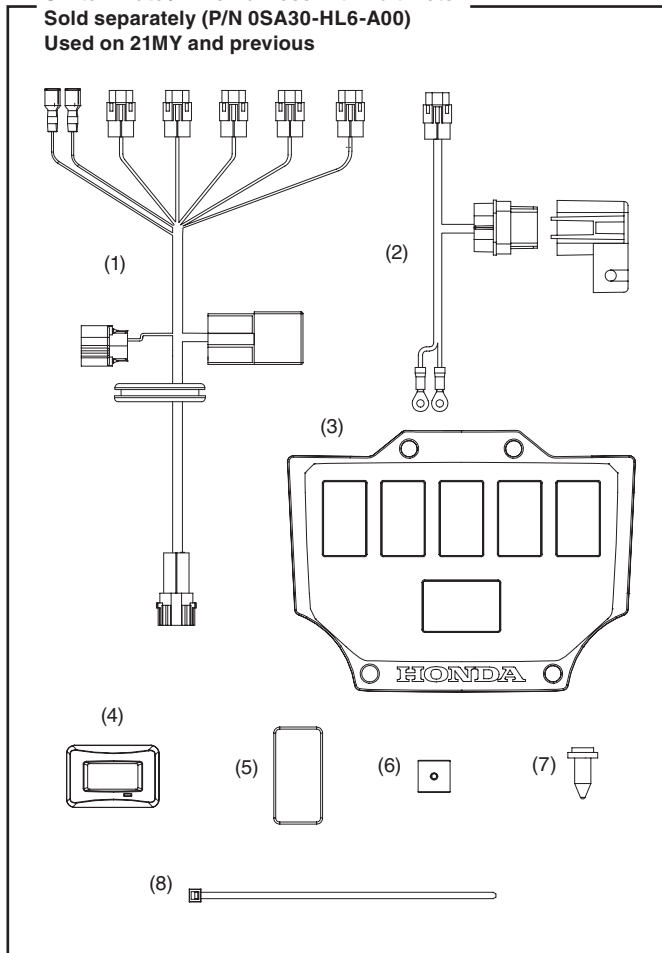

No.	Description	Qty
(1)	Main harness	1
(2)	Battery terminal harness	1
(3)	Switch cover	1
(4)	Voltmeter	1
(5)	Blank plate	4
(6)	Drill stop	1
(7)	Trim clip	4
(8)	Cable tie	8

Fuse Box

Sold separately (P/N 0SS25-HL4-A00)

Used on 22MY ~ present

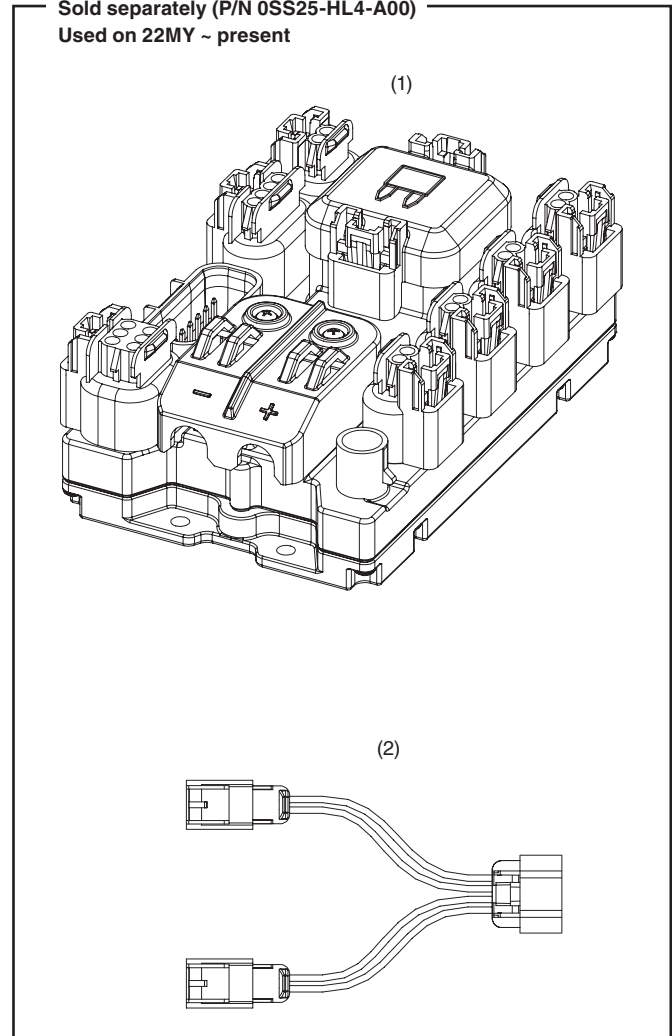

No.	Description	Qty
(1)	Fuse box switcher	1
(2)	Harness, 4-pin to 2-pin (Y-splitter)	1

Busbar

Sold separately (P/N 0SS27-HL6-A00)
Used on 22MY ~ present

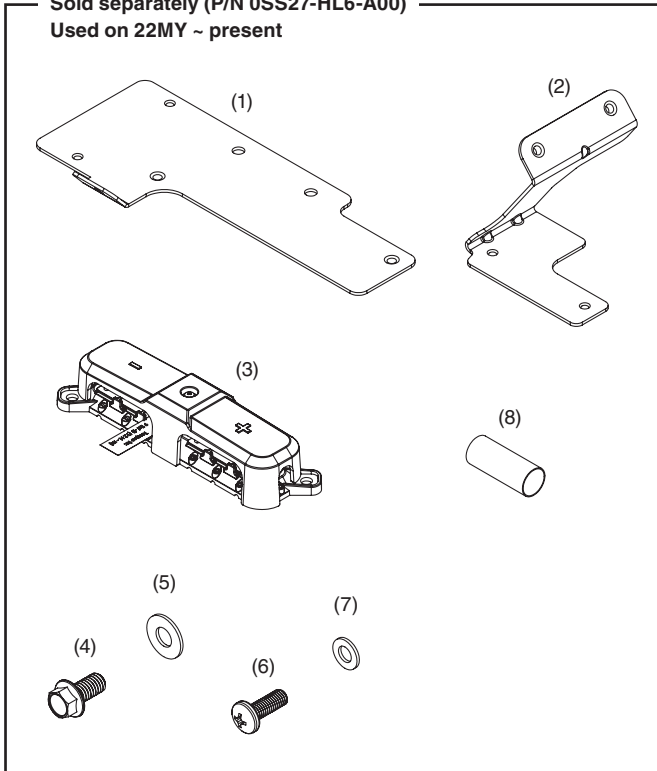

No.	Description	Qty.
(1)	Main bus bar mounting plate	1
(2)	Bus bar lower support bracket	1
(3)	Bus bar	1
(4)	M6 x 12 mm flange screw (8 mm head)	4
(5)	M6 x 14 mm flat washer	4
(6)	Phillips pan-head screw M5 x 14 mm	2
(7)	M5 x 10 mm flat washer	2
(8)	Heat shrink	2

Fuse Box Mount Kit

Sold separately (P/N 0SS26-HL6-A00)
Used on 22MY ~ present

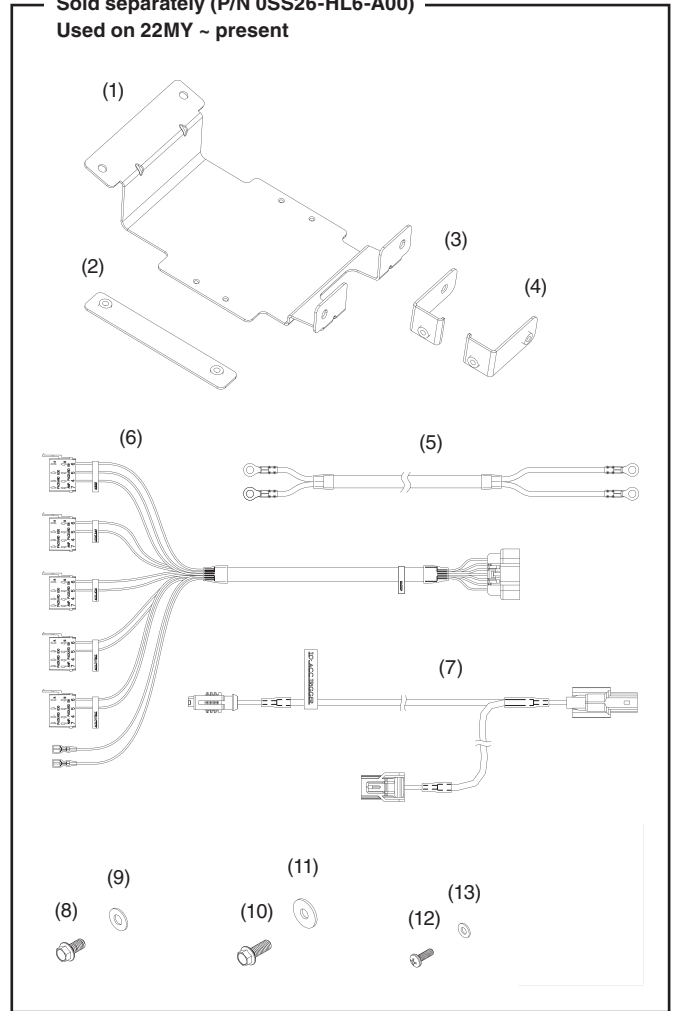

No.	Description	Qty.
(1)	Fuse box mounting plate	1
(2)	Front under bracket	1
(3)	Driver side L-bracket	1
(4)	Passenger side L-bracket	1
(5)	Input power cables	1
(6)	Switch wiring harness	1
(7)	Accessory trigger cable	1
(8)	8 mm hex head M6 flange screw, 12 mm long	4
(9)	M6 flat washer, 14 mm o.d.	4
(10)	8 mm hex head M6 flange screw, 16 mm long	2
(11)	M6 flat washer, 18 mm o.d.	2
(12)	M4 x 0.7 phillips screw, 12 mm long	4
(13)	M4 flat washer	4

TOOLS REQUIRED

Torque wrench
Socket (12 mm)
4 mm hex key or bit socket
5 mm hex key or bit socket
5/16" or 8 mm hex driver
Utility knife or razor blade
Heavy duty wire cutter

TORQUE CHART

Tighten all screws, bolts, and nuts to their specified torque values. Refer to the Service Manual for the torque values of the removed parts.

Item	N-m	kgf-m	lbf-in
6 mm fasteners	6.8	0.68	60
8 mm fasteners	17	1.7	150

USE AND CARE INFORMATION

- Check the accessory mounts frequently and re-tighten if necessary.
- Never use petroleum solvents such as gasoline, thinner and benzine to clean this accessory. Also do not use acid or alkaline cleaners.

NOTE:

- **Fuel recommendation - unleaded gasoline, pump octane number of 91 or higher.**
- **Product will intake and expel both air and loose materials with high force and velocity. Install product on roll cage, so air inlet is not blocked. Do not place face, hair, extremities, clothing, or other loose material in front of air inlet or outlet during use.**

CAUTION:

Moving parts are sharp and could cause personal injury. Keep fan safety guard and exhaust cover in place while operating and after service. Disconnect product from power source before servicing.

INSTALLATION

For 21MY and previous, install Switch plate/wire harness with volt meter before installation.

For 22MY and future, install Busbar, Fuse Box & Fuse Box Mount kit before installation.

1. Remove the five trim clips from the vent cover and remove.

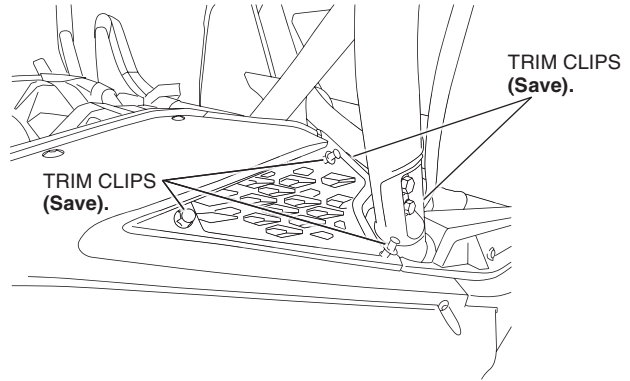

2. Remove the eight trim clips from the snorkel cover.

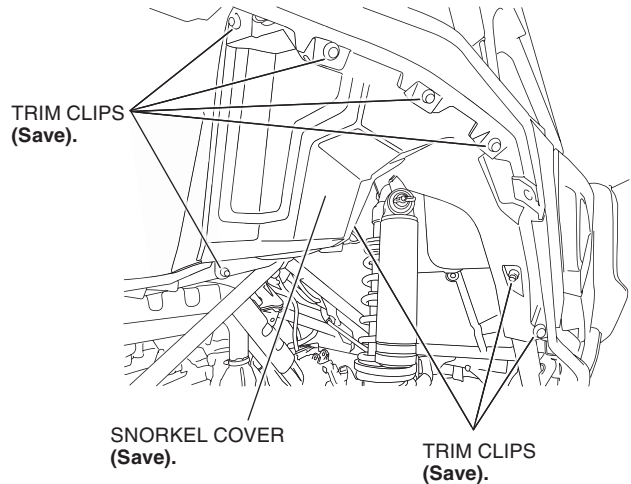

3. Remove the two trim clips from the right rear over fender and remove them. Remove the snorkel cover from the vehicle.

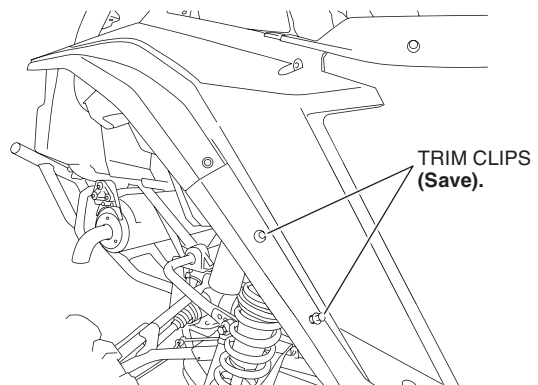

4. Locate the snorkel duct and loosen the hose clamp.

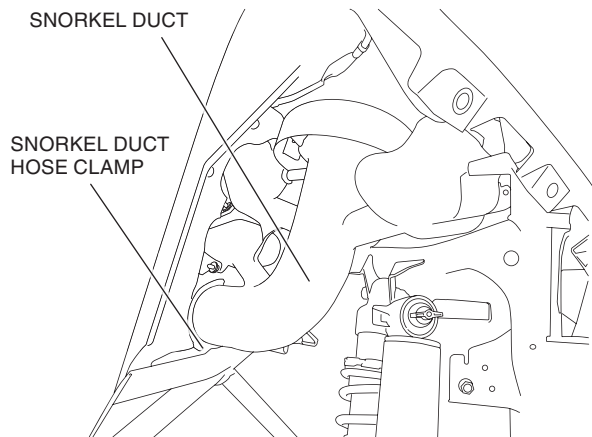

5. Remove the three trim clips from snorkel duct.

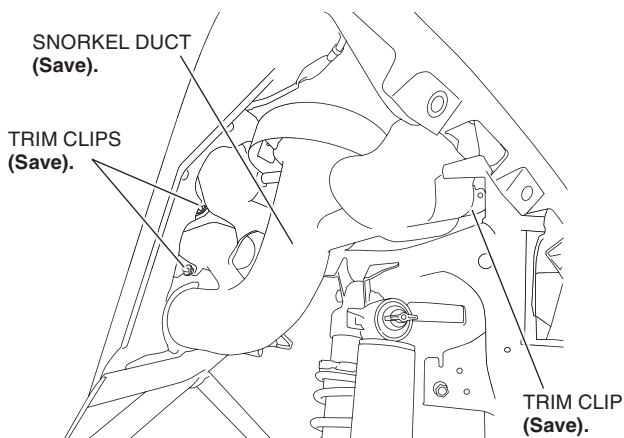

6. Twist the plastic latches to the unlock position then remove the air cleaner lid.

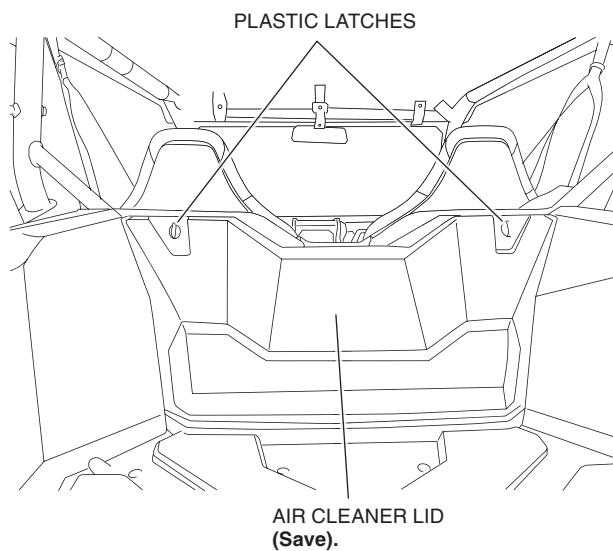

7. Remove the two trim clips from the upper portion of the snorkel duct and remove the snorkel duct.

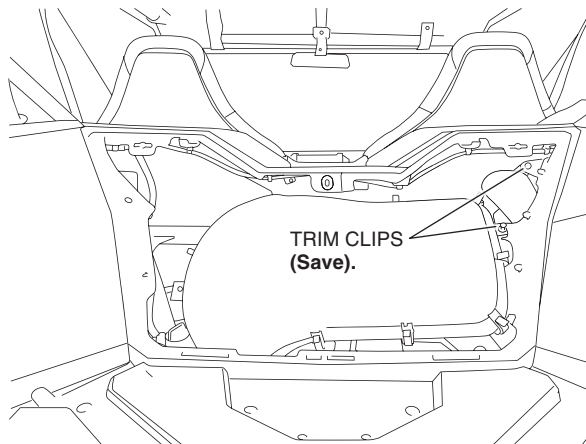

8. Install the grommet into the hole of the side cover.

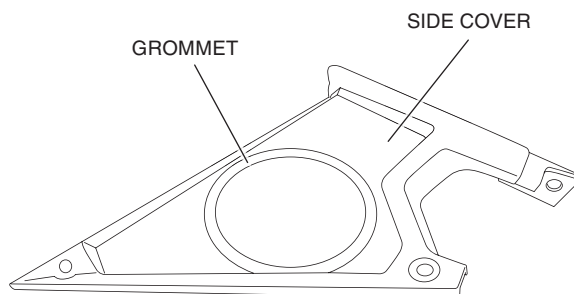

9. Install the side cover to the vehicle and secure it using four trim clips removed in Step 1.

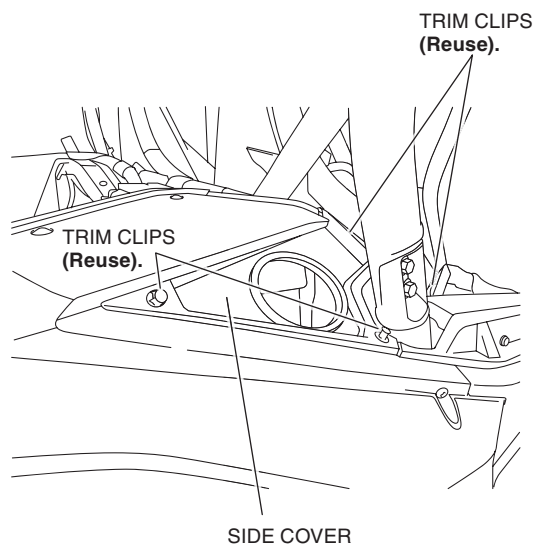

10. Install the upper tube into the side cover through the grommet as shown.

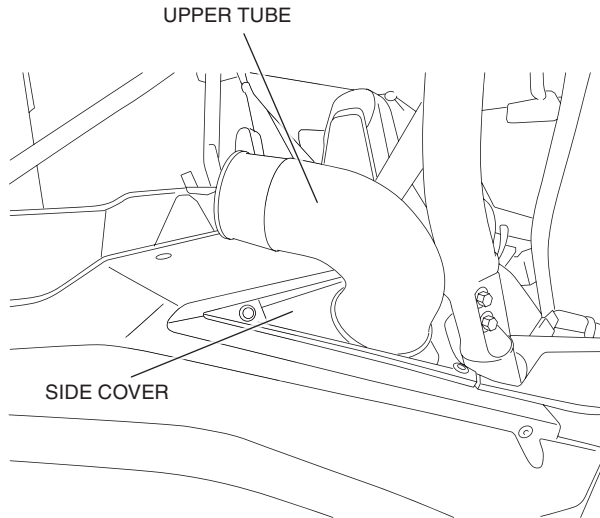

11. Install the coupler to the lower tube and secure the coupler with the hose clamp size #48. Loosely install another hose clamp size #48 to the free end of the coupler and attach lower tube to the upper tube and to the stock air box inlet and tighten all hose clamps shown.

NOTE: There is a bead around the upper tube and lower tube to indicate how deep to insert the coupler into the tubes.

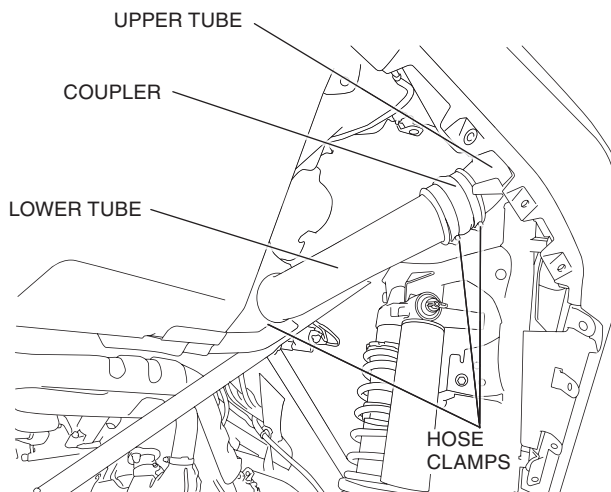

12. Install the snorkel cover. Use the ten trim clips removed in Steps 2 and 3 to secure the snorkel cover.

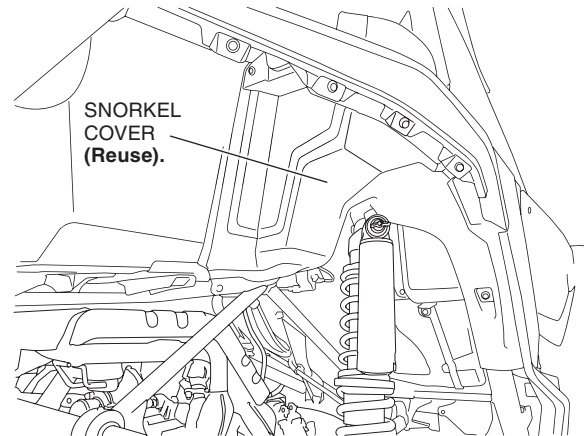

13. Decide if you want to mount the particle separator to the rear upper or lower OPS tube. For the upper OPS tube use the 2 in straps. For the lower OPS tube use the 35 mm straps. When placing the straps on the bars, wrap the bar with the plastic bag the straps came in to avoid scratching the OPS tube during installation. After the straps are on the bar, add the clamp pivot to the strap by using two 8 mm washers on the outside of the strap and the 8 x 50 mm button head cap screw and 8 mm locknut. Hand tighten only so that the straps can still move freely on the OPS tube and be repositioned as necessary.

2 in STRAPS (UPPER OPS INSTALLATION)

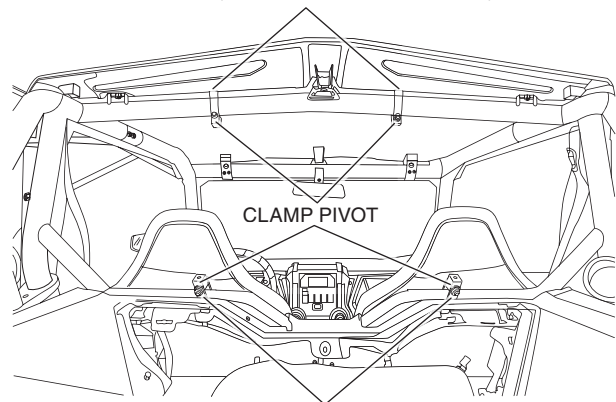

35 mm STRAPS (LOWER OPS INSTALLATION)

14. Attach the clamp adapter to the particle separator using two 6 mm washers and two 6 mm button head cap screws. Use a drop of threadlocker on the end of the 6 mm button head cap screw threads and tighten securely. Attach the clamp L-bracket to the clamp adapter with 8 mm washer and 8 x 22 mm button head cap screw. Install the clamp L-bracket with the L facing inward or outward, select 1 of 5 hole positions, as well as rotate the L-bracket into one of several teeth locking positions. Hand tighten the L-bracket and adjust as necessary until the desired position is determined. The particle separator can be mounted in any location as long as it is horizontal and level so that the heavier debris will be ejected by the fan out of the bottom as efficiently as possible.

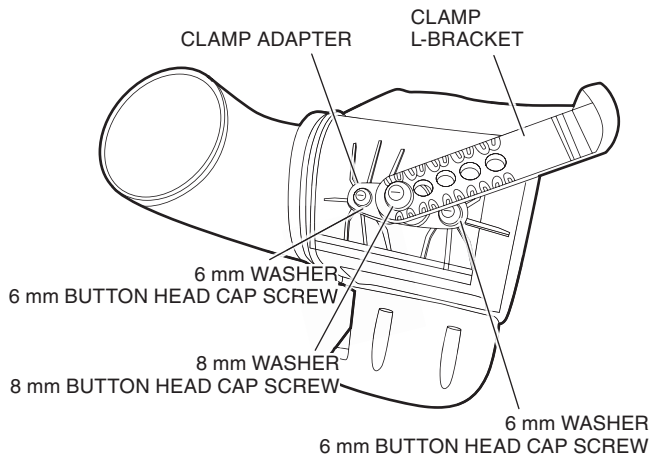

15. Attach the clamp L-bracket to the clamp pivot using the 8 mm washer and the 8 x 22 mm button head cap screw. Do this for both sides and hand tighten to verify desired position. Once position is verified, tighten the straps securely to the bars.

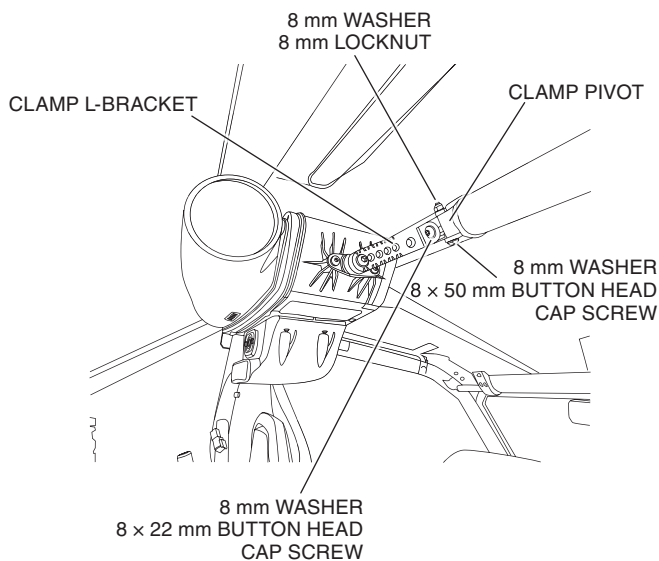

16. Support the Particle Separator Unit then add a drop of Threadlocker to the ends of the four 8 x 22 mm Button Head Cap Screws, one at a time, previously installed in Steps 14 and 15.

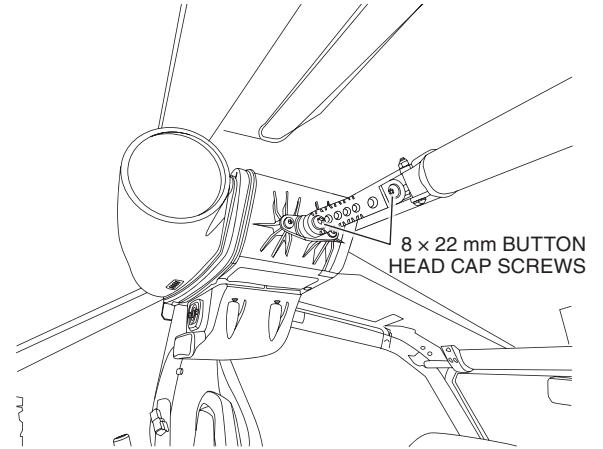

17. Carefully slide the flex duct end cuff over the 3.5 in ID flexible duct until the end of the duct reaches the inside bead of the flex duct end cuff as shown.

NOTE: The position of the hose clamp groove is away from the end of the Flexible Duct.

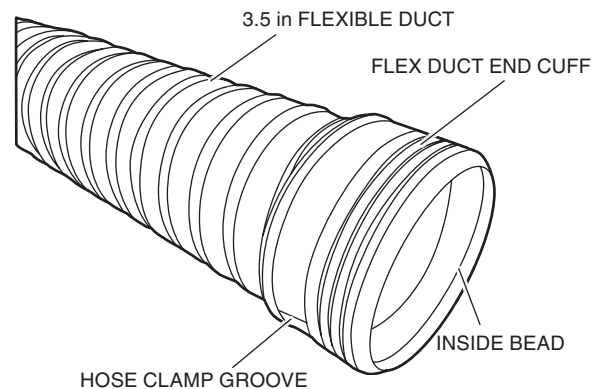

18. Place the hose clamp size #56 onto the flex duct end cuff clamp groove and slide everything over the upper tube until the flex duct end cuff reaches the bead on the upper tube as shown. Tighten the hose clamp.

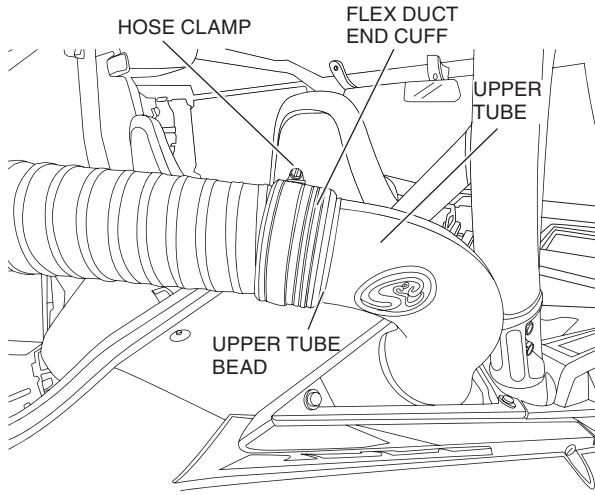

19. Position the flexible duct on the particle separator in the desired position and mark the ducting 2" past the particle separator outlet.

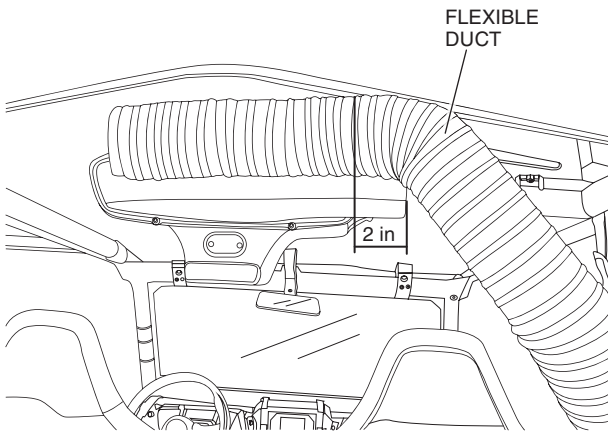

20. Using a utility knife, cut the flexible duct at the mark keeping the blade between the spiral wires then use wire cutters to cut the wire at the end as shown.

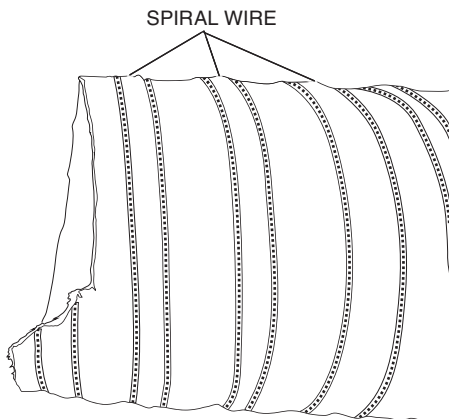

21. Carefully slide the flex duct end cuff over the 3.5 in ID flexible duct until the end of the duct reaches the inside bead of the flex duct end cuff as shown.

NOTE: The position of the hose clamp groove is away from the end of the Flexible Duct.

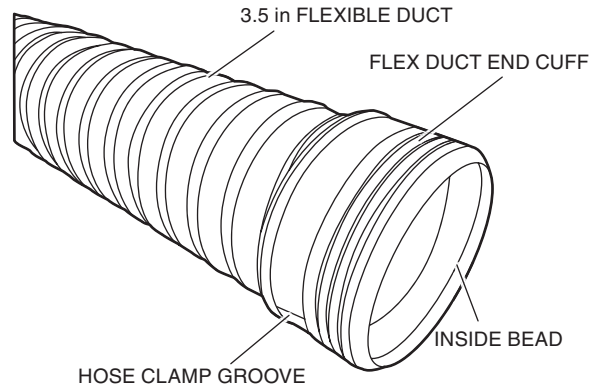

22. Place the hose clamp size #56 onto the flex duct end cuff clamp groove until the flex duct end cuff covers at least 2" of the particle separator outlet as shown. Tighten the hose clamp.

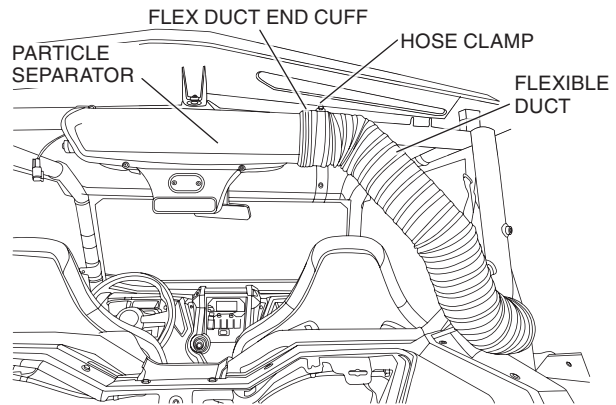

23. Remove the (12) trim clips securing the center console, then remove the center console. Set all parts aside to be reinstalled. (Same clips for 22MY)

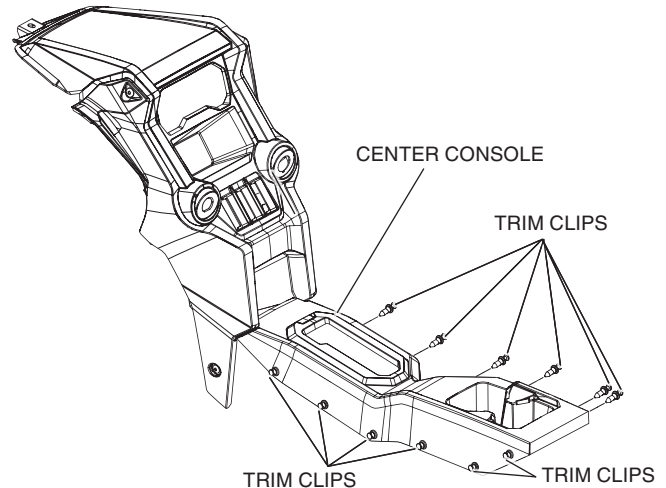

24. Remove the upper center console between the seats by pulling it towards the front of the vehicle and releasing the prong from the grommet.

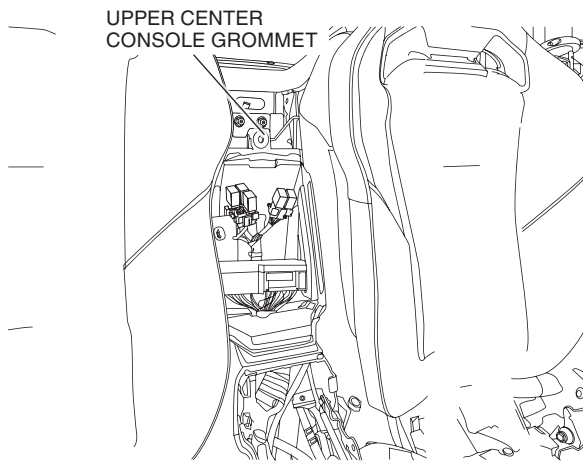

Follow steps 25 - 32 for 21MY and previous. Skip to 33 for 22MY and future.

25. Remove the four trim clips that hold the switch cover then remove the switch cover.

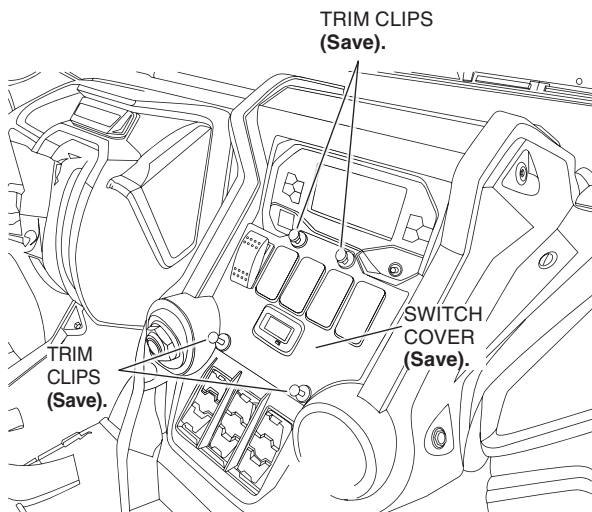

26. Remove a desired switch cover plate then place the particle separator rocker switch into the open space.

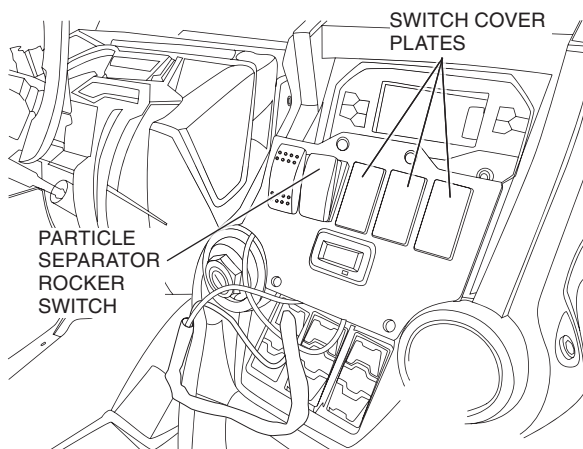

27. Remove hood and four trim clips holding the rubber mud guard and move it out of the way to access the back side of the switch panel compartment.

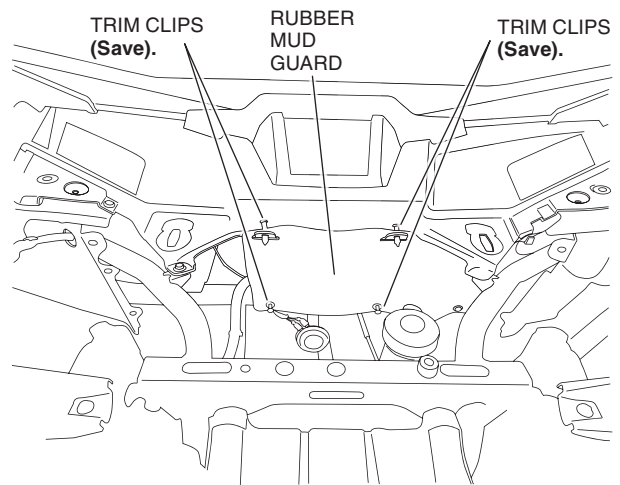

28. Route the wire harness fan connector through the grommet located in the switch panel compartment. Leave the power connector, power fuse, and rocker switch connectors inside the switch panel compartment.

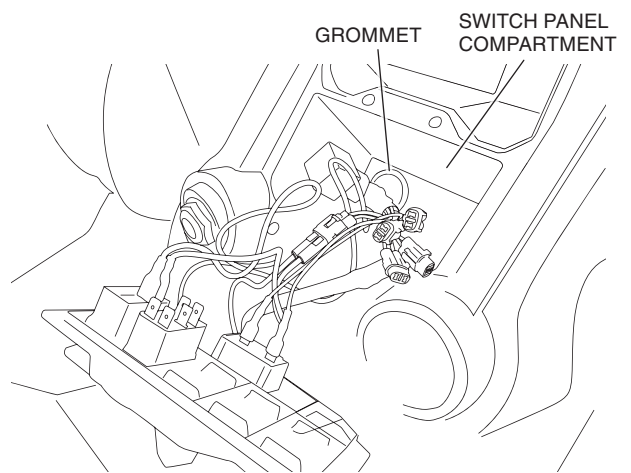
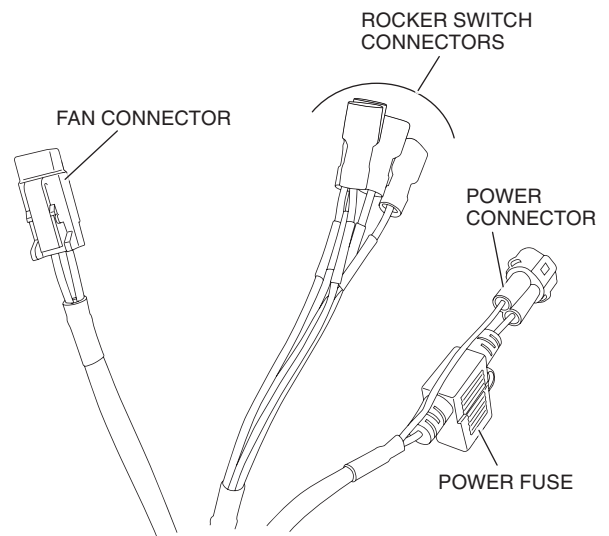

29. Route the fan connector from the grommet back through the center console area and up along side the OPS to the fan on the particle separator. Connect the wire harness fan connector to the fan connector. Use cable ties to secure the harness in several locations along side the main harness as shown in the illustrations.

<Engine Compartment>

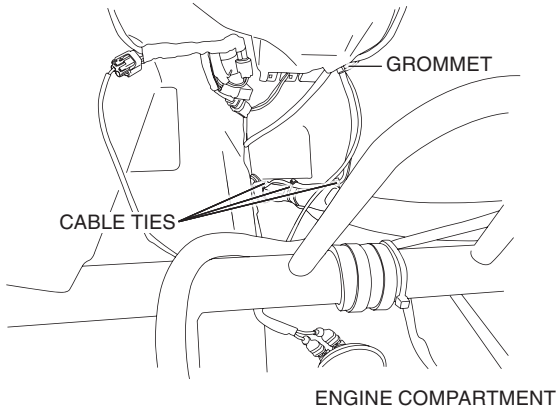

ENGINE COMPARTMENT

<Center Console>

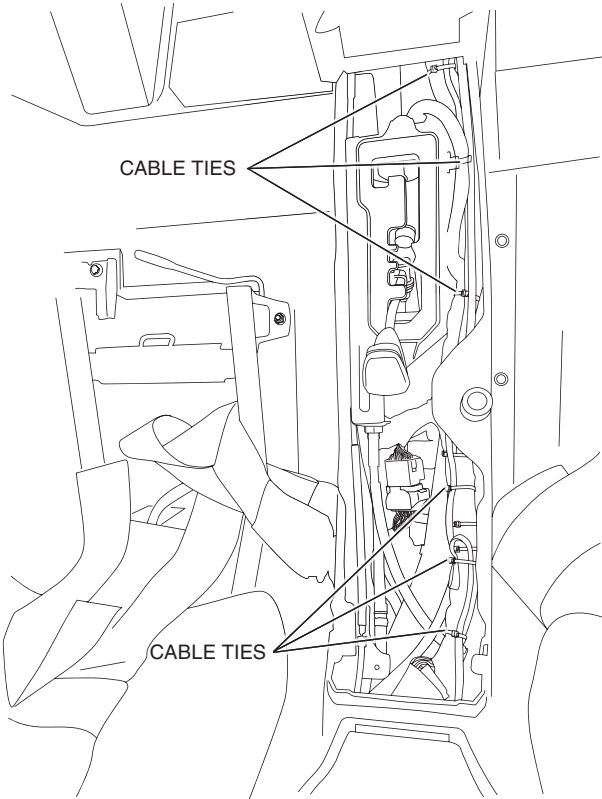

CENTER CONSOLE

<Upper Center Console>

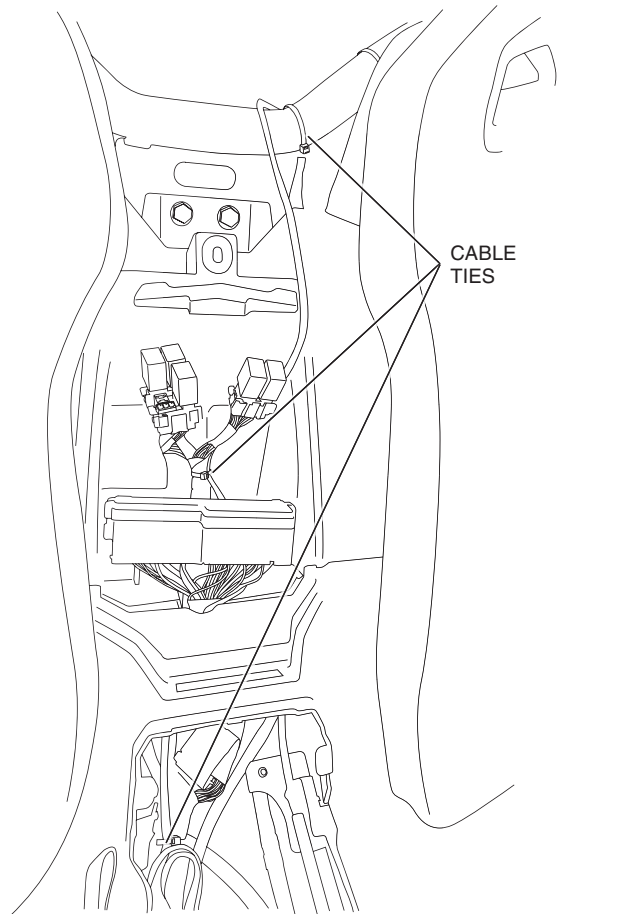

UPPER CENTER CONSOLE

<OPS>

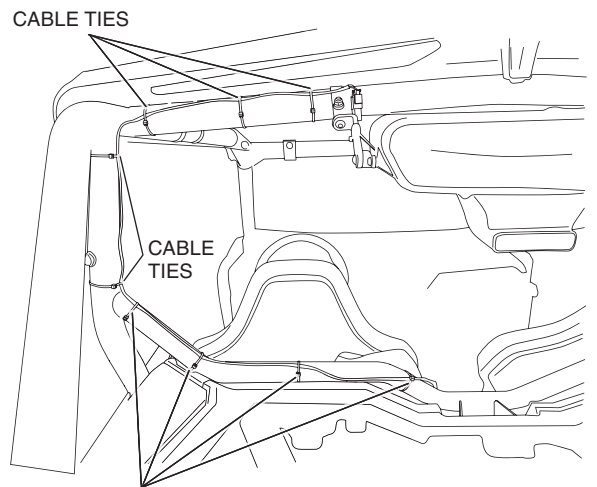

CABLE TIES

OPS

SPARE ACCESSORY PLUGS (FOR TALONS EQUIPED WITH THE SWITCH PLATE)

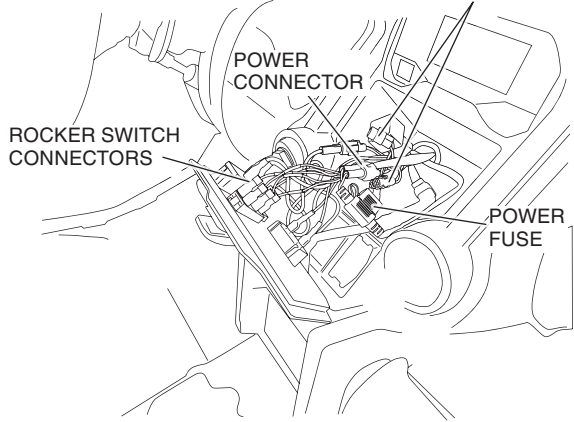

30. Reinstall the rubber mud guard and the four trim clips removed in Step 27 and replace the hood.

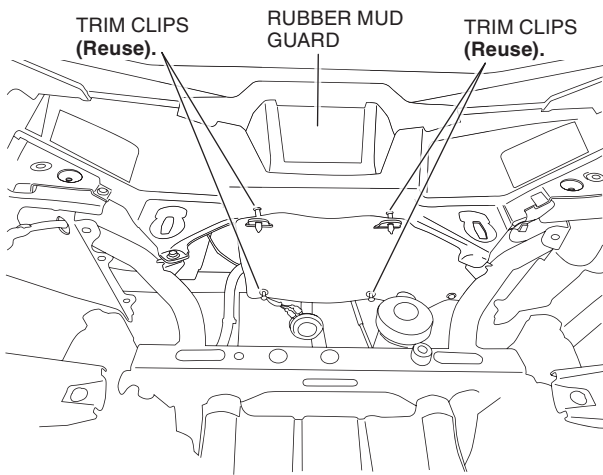

31. Reinstall the switch cover and four trim clips removed in Step 25. Proceed to Step 36.

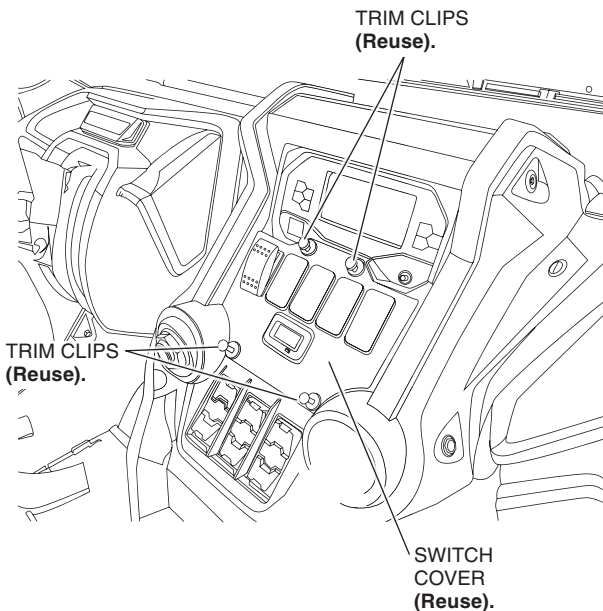

32. For **22MY** remove rear hood as per service manual.

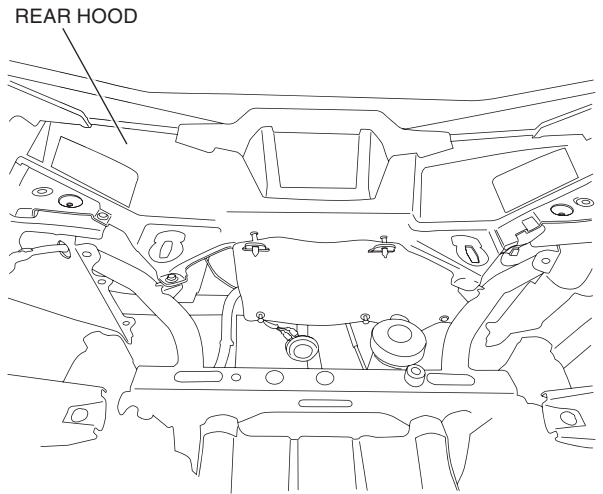

33. Route the fan connector from under the rear hood through the center console area and up along side the OPS to the fan on the particle separator. Connect the wire harness fan connector to the fan connector. Use cable ties to secure the harness in several locations along side the main harness as shown in the illustrations.

<Engine Compartment>

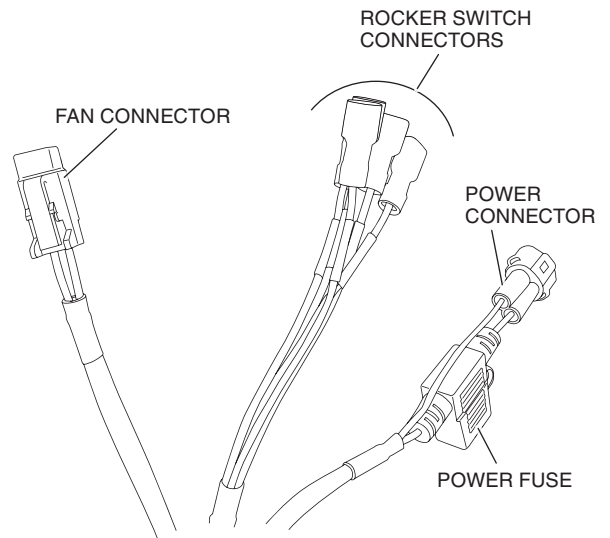

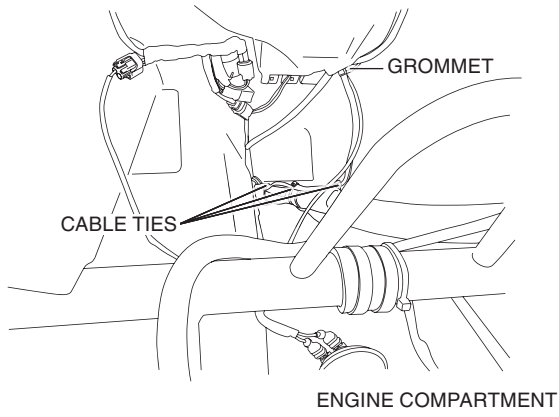

<Center Console>

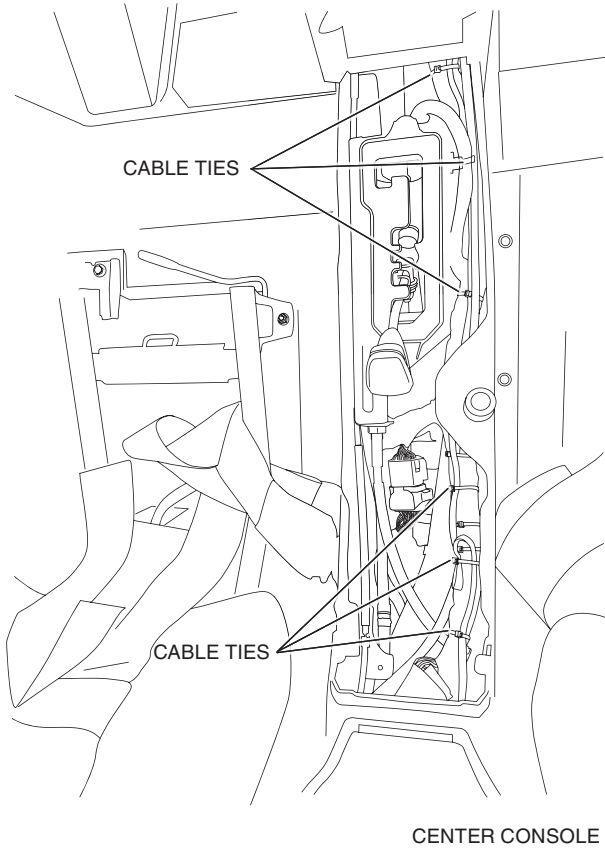

<Upper Center Console>

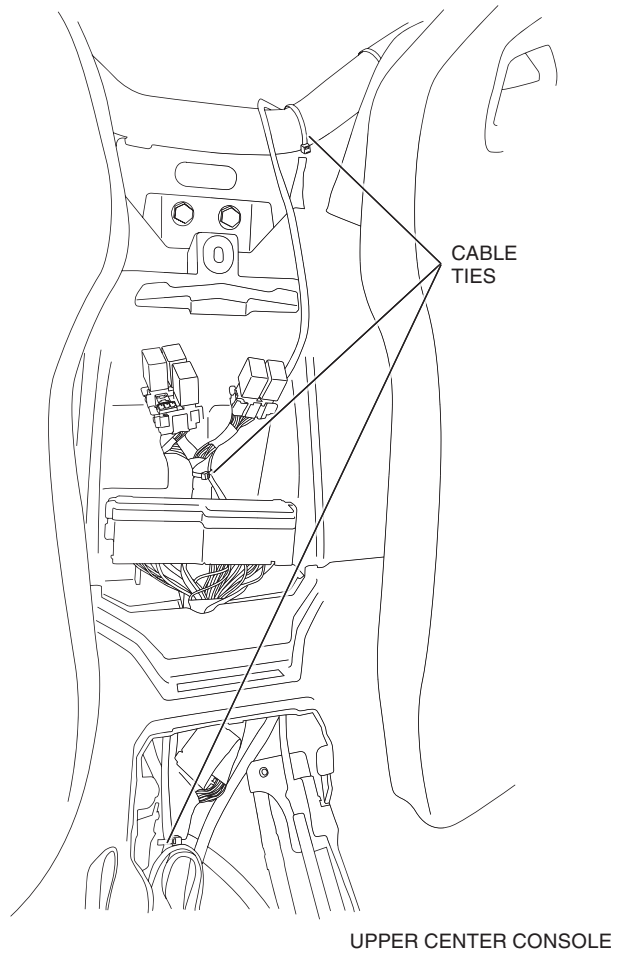

<OPS>



34. Route rocker switch connectors to accessory switch behind IP.

ACCESSORY SWITCH LOCATIONS

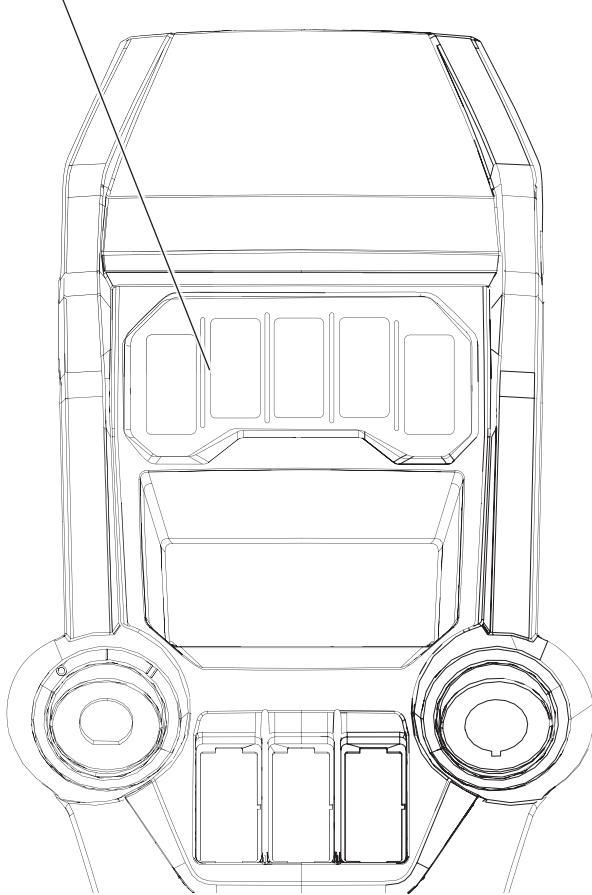

35. Route power connector using supplied sub-harness to fuse box. Connect the power connector to the fuse box adapter harness and then connect the adapter harness to one of the available connector positions on the fuse box. Once the adapter harness is connected to the fuse box, you can slide the locking tab on the adapter harness connector down (towards the fuse box) to lock it into place. Do not forget to slide the locking tab away and then depress the retaining clip of the connector when you wish to remove the connector from the fuse box. Connect the five rocker switch connectors to the rocker switch.

NOTE: The rocker switch connectors are labeled with a number corresponding to the numbers on the rocker switch.

FUSE BOX ADAPTER
(FOR TALONS EQUIPPED WITH THE FUSE BOX)

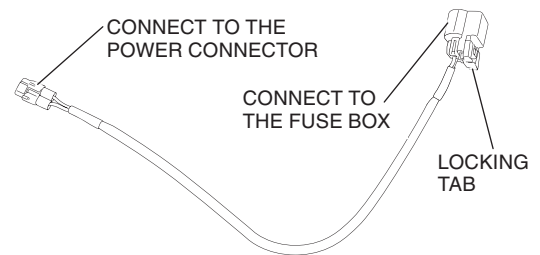

FUSE BOX CONNECTOR POSITIONS
(FOR TALONS EQUIPPED WITH THE FUSE BOX)

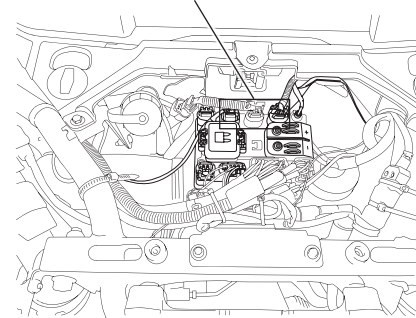

36. Reinstall the upper center console removed in Step 24. Make sure to insert the prong into the grommet.

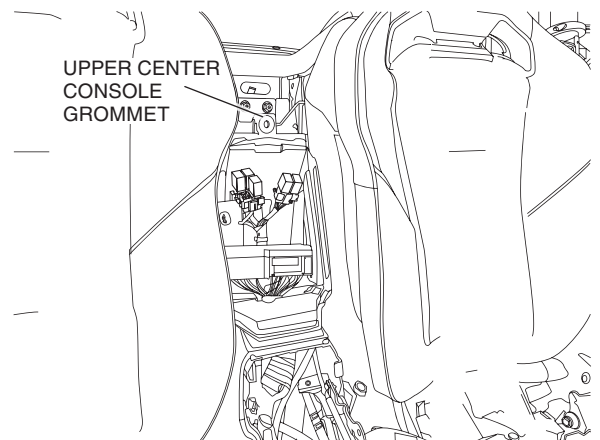

37. Reinstall the center console and (12) trim clips removed in Step 23.

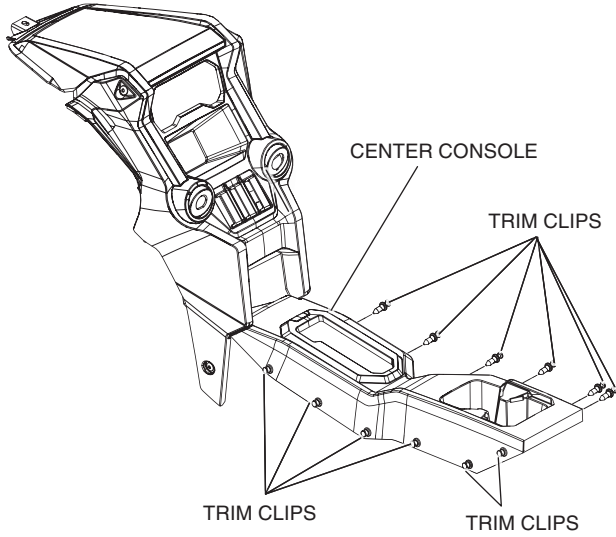

38. Reinstall the air cleaner lid removed in Step 6. Twist the plastic latches to the lock position and flip the levers down.

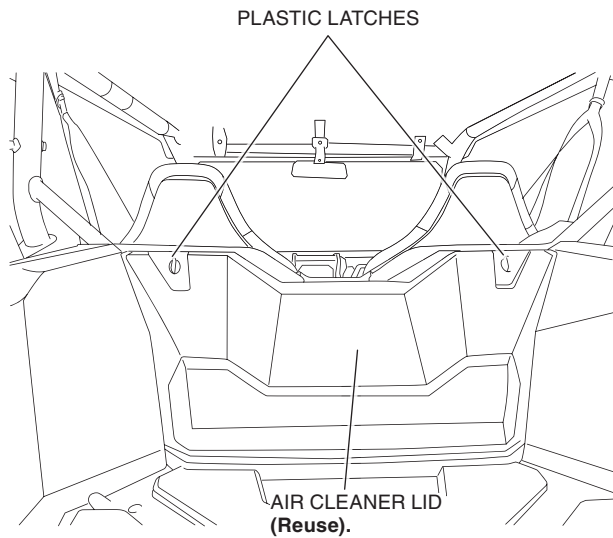

39. When the ignition is in the “key on” position or the engine is running, check that the particle separator fan turns on when the rocker switch is in the “on” position and turns “off” when the rocker switch is in the “off” position.

NOTE: The particle separator should be left “on” whenever your engine is running.

<Upper OPS Tube Installation>

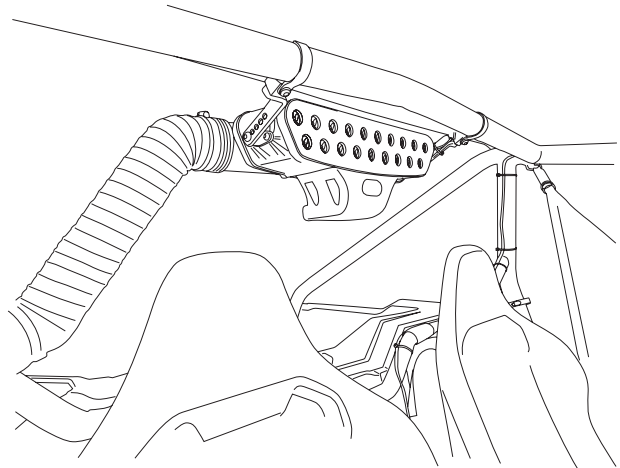

<Lower OPS Tube Installation>

